



TRE#DO
ENGINEERING • DEVELOPMENT

CITY OF NEGAUNEE
DNR LAND AND CONSERVATION GRANT
141 RAIL STREET
NEGAUNEE, MI 49866

DATE:
1/6/2025

PLANSET LABEL:
CITY OF NEG FLOOR PLAN

PROPOSED
ICE RINK
FLOOR PLAN

A101

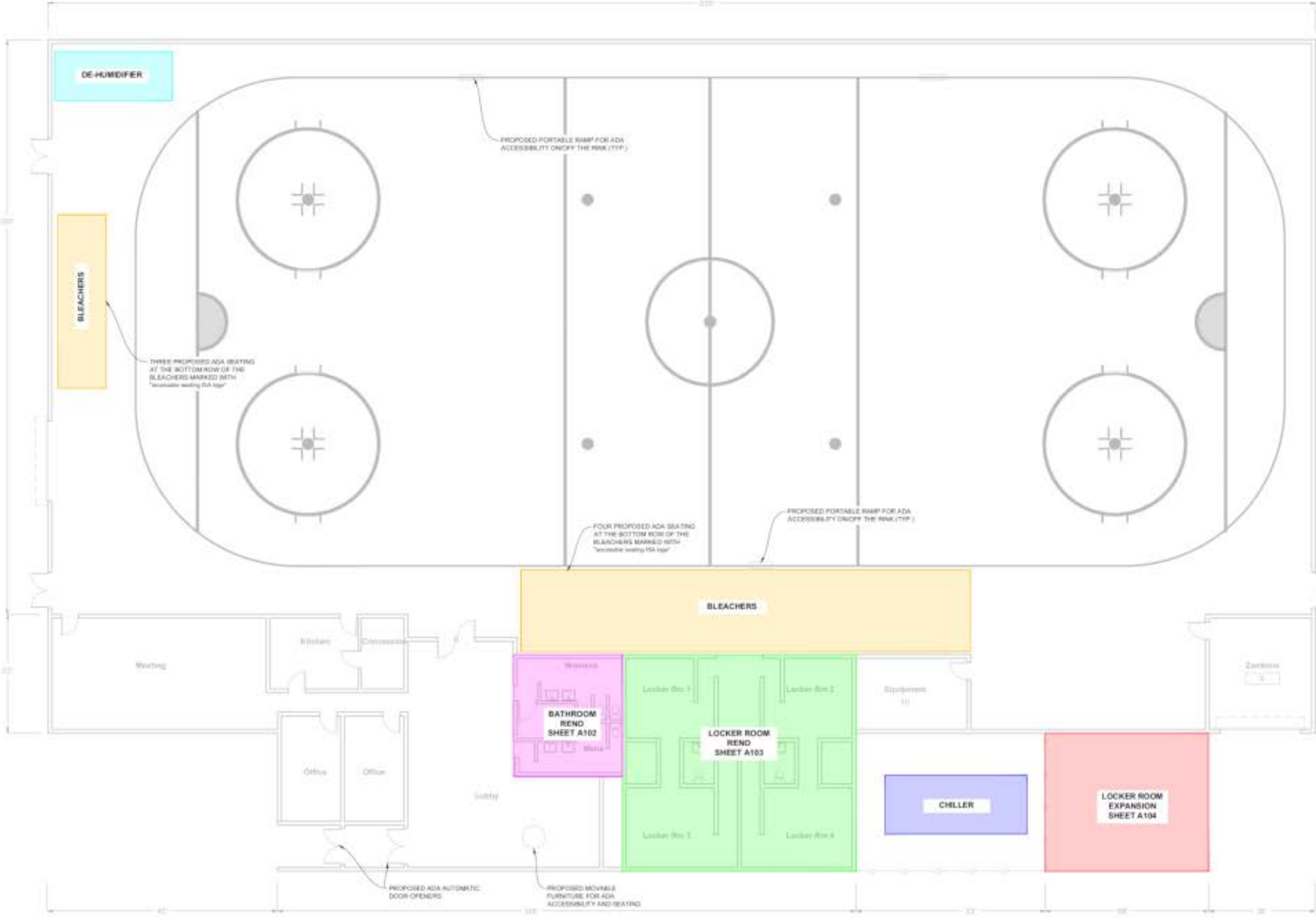



TRE#DO
ENGINEERING • DEVELOPMENT

Womens

REMOVE & REPLACE TOILET AND DIVIDING WALL WITH ADA ACCESSIBLE TURNING RADIUS AND GRAB BARS

REMOVE & REPLACE BATHROOM SINKS WITH ADA ACCESSIBLE FIXTURES

REMOVE & REPLACE BATHROOM SINKS WITH ADA ACCESSIBLE FIXTURES

REMOVE & REPLACE TOILET AND DIVIDING WALL WITH ADA ACCESSIBLE TURNING RADIUS AND GRAB BARS

Mens

PROPOSED BABY CHANGING STATION

CITY OF NEGAUNEE
DNR LAND AND CONSERVATION GRANT
141 RAIL STREET
NEGAUNEE, MI 49866

DATE:
1/6/2025
02/19/2026

PLANSET LABEL:
CITY OF NEG FLOOR PLAN
ICE RINK WALK THROUGH

PROPOSED BATHROOM FLOOR PLAN

A102

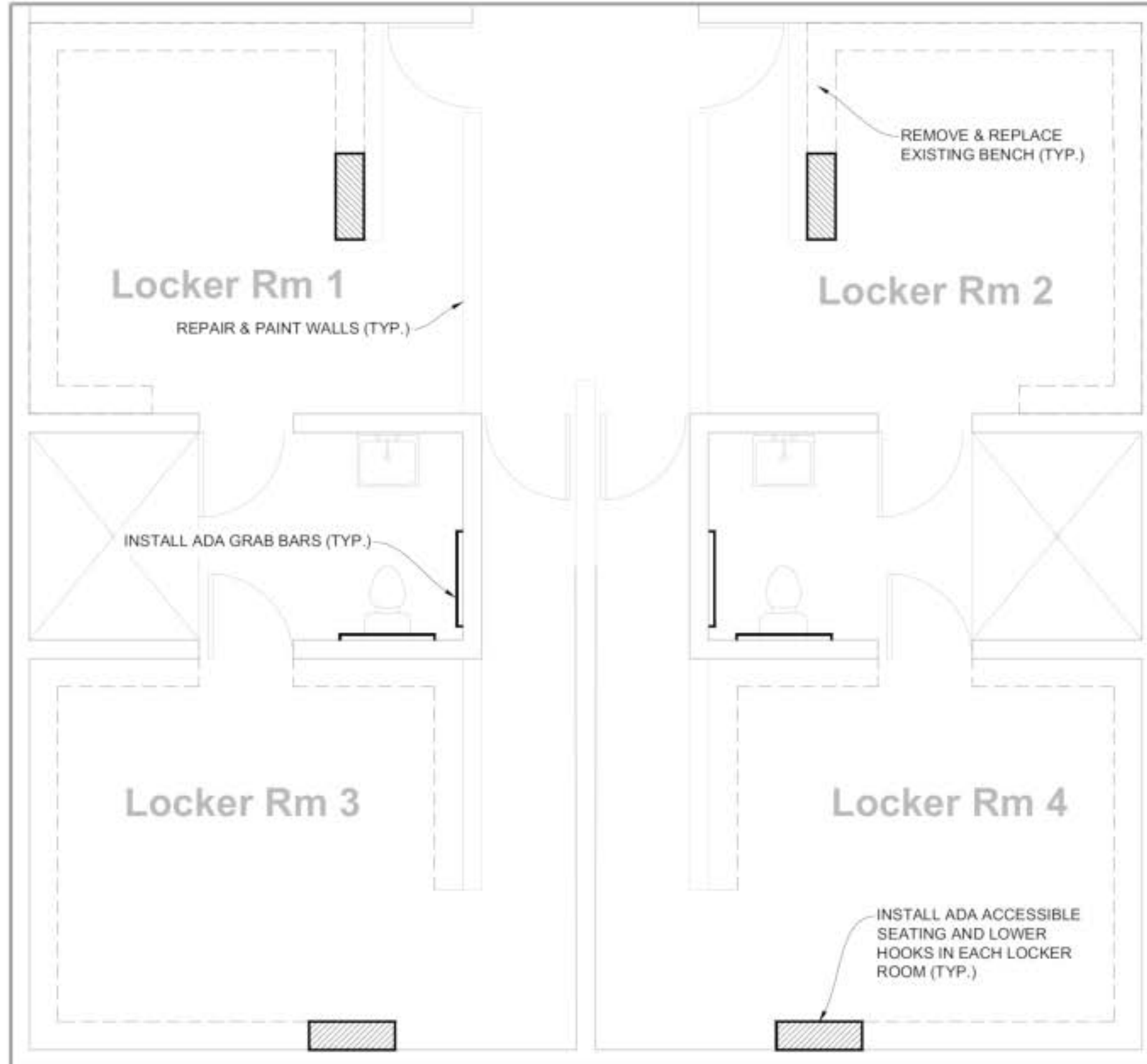

TRE#DO
ENGINEERING • DEVELOPMENT

CITY OF NEGAUNEE
DNR LAND AND CONSERVATION GRANT
141 RAIL STREET
NEGAUNEE, MI 49866

DATE:
1/6/2025
02/19/2026

PLANSET LABEL:
CITY OF NEG FLOOR PLAN
ICE RINK WALK THROUGH

PROPOSED
LOCKERROOM
RENOVATION
FLOOR PLAN

A103



EXISTING ICE RINK

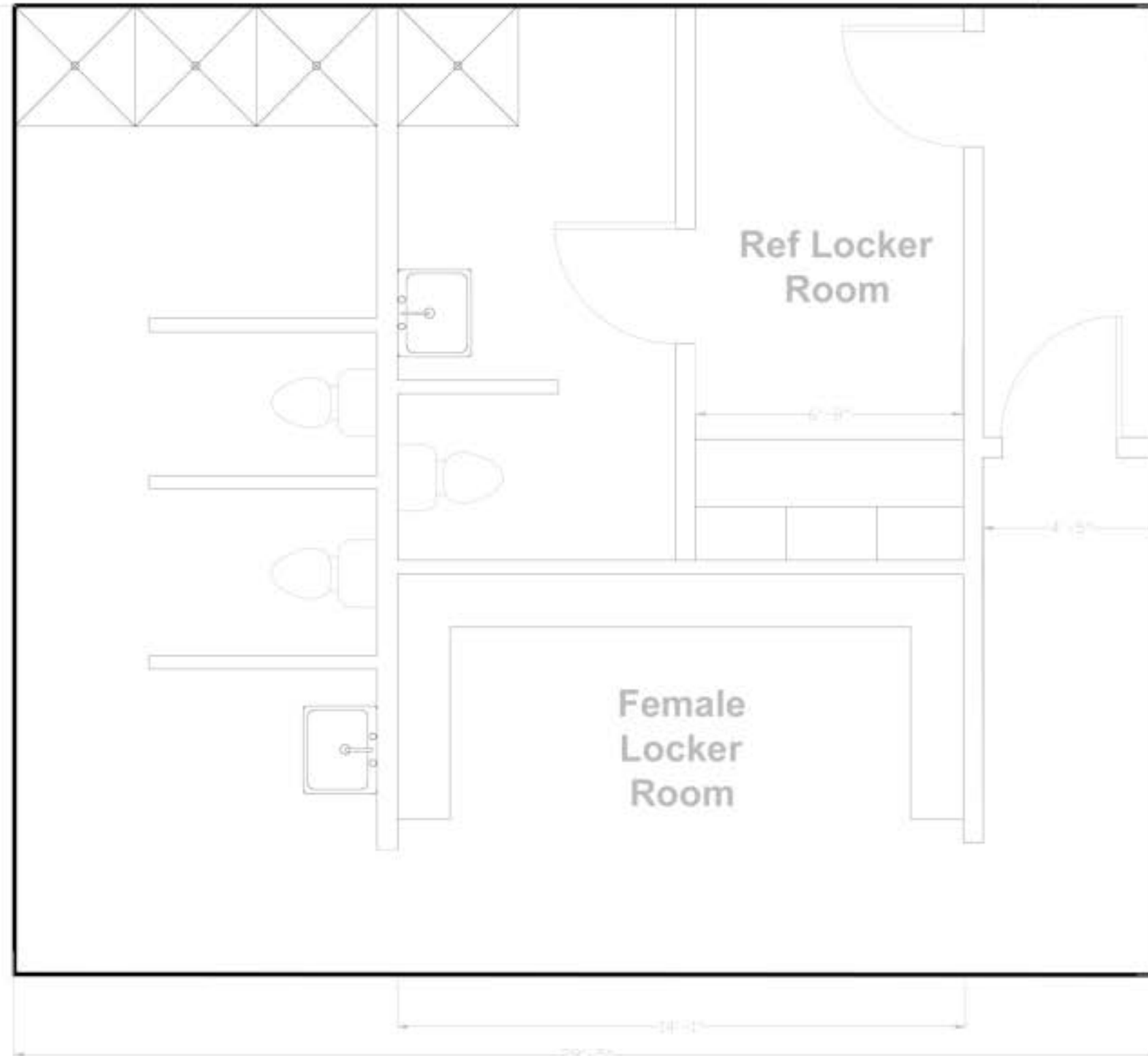

TRE#DO
ENGINEERING • DEVELOPMENT

CITY OF NEGAUNEE
DNR LAND AND CONSERVATION GRANT
141 RAIL STREET
NEGAUNEE, MI 49866

PLANSET LABEL:	DATE:
CITY OF NEG FLOOR PLAN	1/6/2025
ICE RINK WALK THROUGH	02/19/2026

PROPOSED
LOCKERROOM
EXPANSION
FLOOR PLAN

A104

