

**BADGER PRAIRIE  
COUNTY PARK  
EXISTING SITE**

① Playground

B Bench

G Grill

P Picnic Table  
(Fixed)



0 15 30



FEBRUARY 28, 2024

# PROPOSED site plan





# primary play container - play elements slate

\*all finishes/colors of play equipment and surfacing tbd

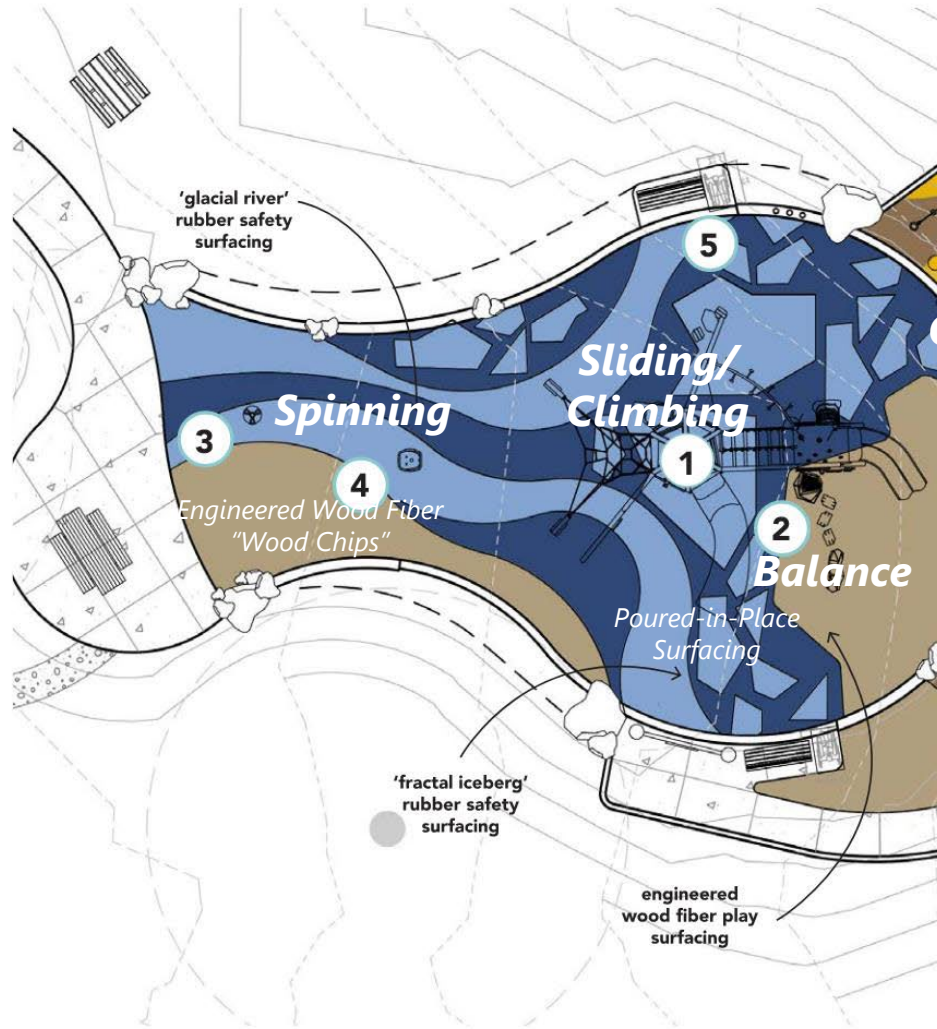

1



1



2



3



4



5

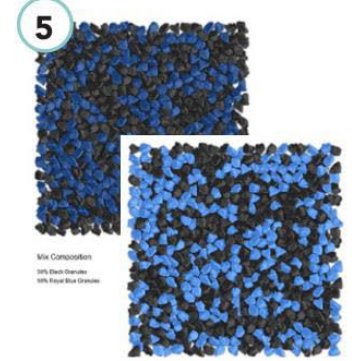

Mix Composition:  
100% Black Granules  
100% Black Blue Granules

Mix Composition:  
100% Black Granules  
100% Black Blue Granules





# primary play container - site rendering





# sensory play container - play elements

\*all finishes/colors of play equipment and surfacing tbd

1



# site plan - site furnishing

\*all selections follow Dane County standards where applicable; select finishes tbd

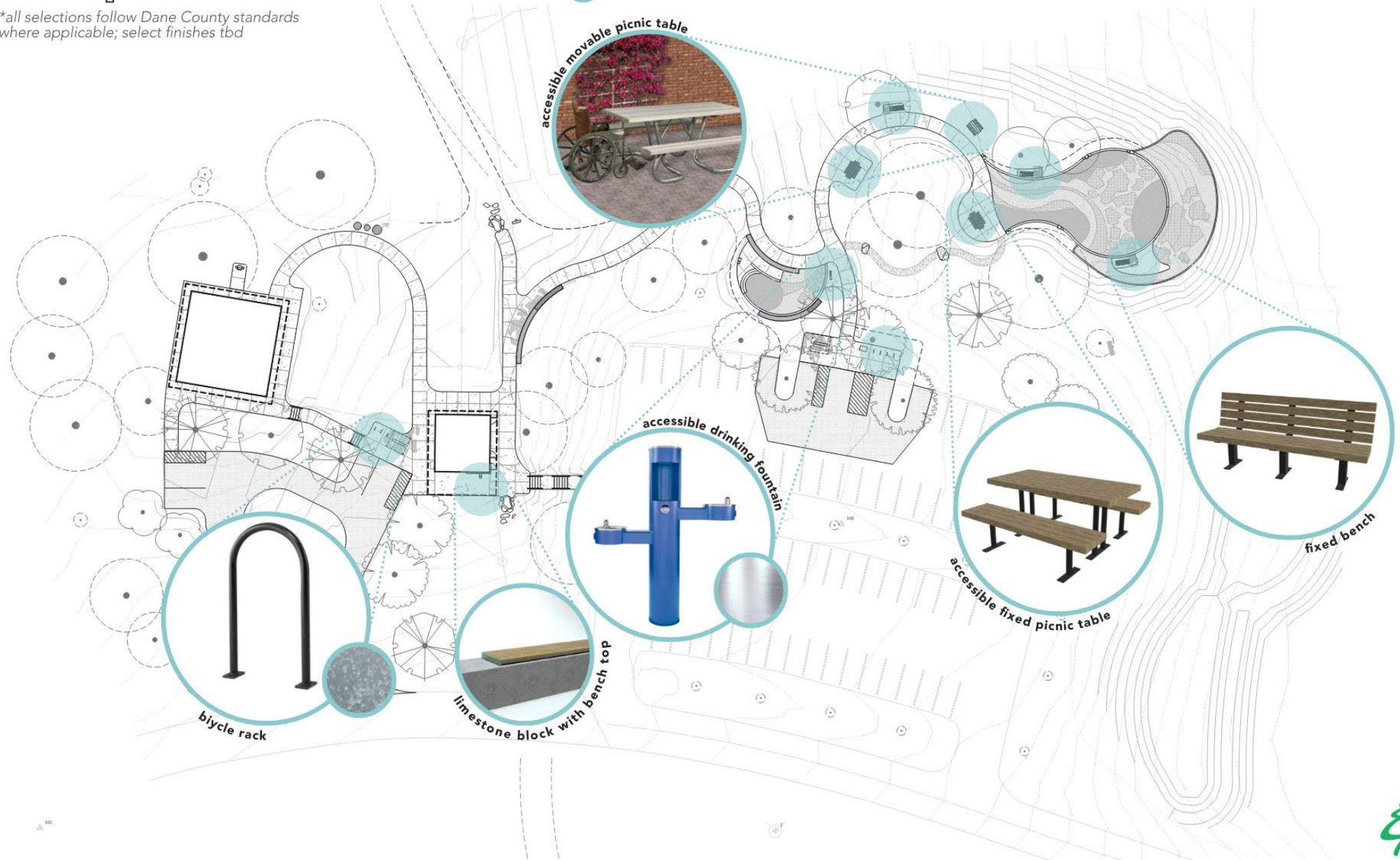



# PROPOSED RESTROOM ACCESSIBILITY IMPROVEMENTS

Adjustable Changing Station



ADA Compliant Sinks



Grab Bars and Partition Layout

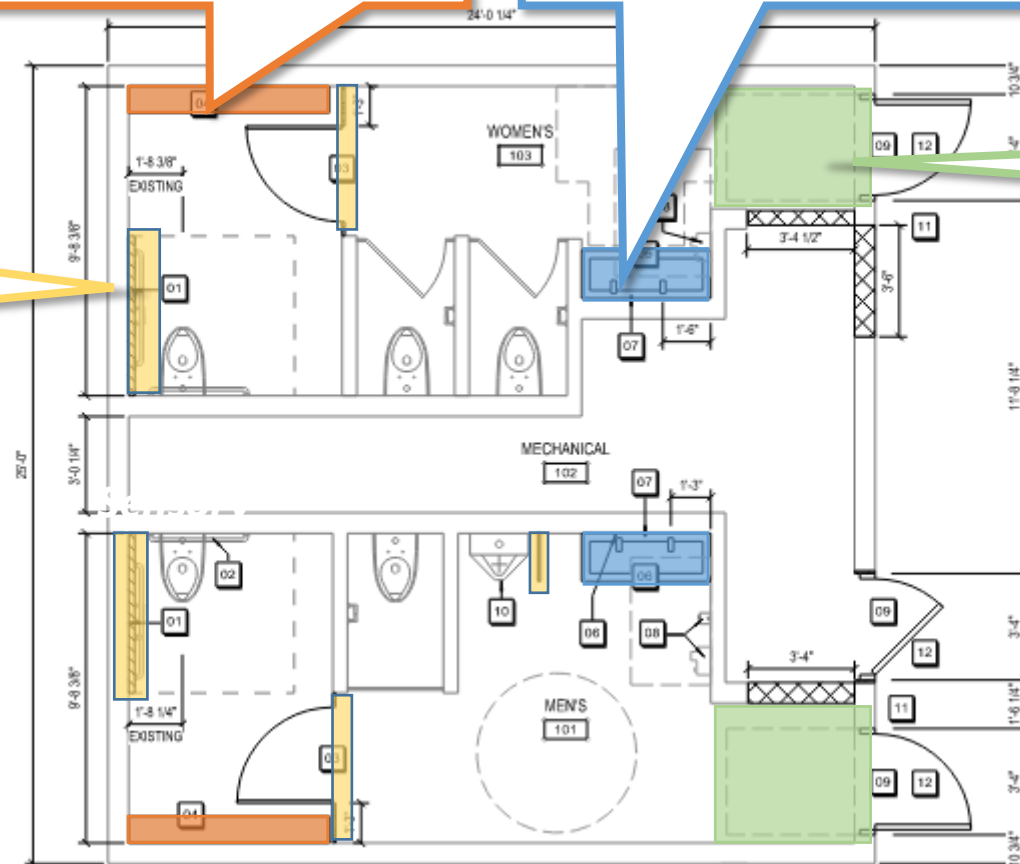

Entry Layout  
And New Doors

# Schedule *(tentative)*

**Final Plans and Bidding**

**April 2025**

**Contractor Mobilization**

**Summer 2025**

**Construction**

**Summer 2025 – Fall 2025**

**Park Fully Open**

*(\* - restoration complete and established)*

**Spring 2026\***

**Ribbon Cutting**

**Spring/Summer 2026**

