

# mart cart®

## OWNER'S MANUAL

Effective Date:

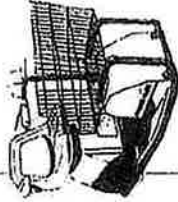

**Mart Cart®**  
Model #02002



**MARTIMATE™**  
Model #01001-M



**Mart Shopper™**  
Model #01001-MS

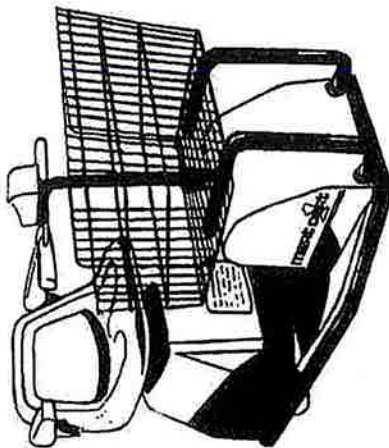

# mart cart®

is a quality product line of  
**Assembled Products™ Corporation**

## 1-800-548-3373

115 E. Linden · Rogers, Arkansas 72756 USA  
Phone: (479) 636-5776 · Fax: (479) 636-3245  
Web site: [www.martcart.com](http://www.martcart.com)

PRINTED IN THE USA

SPECIFICATIONS SUBJECT TO CHANGE WITHOUT NOTICE

NO-MART-CART-04-0000000000

### CONGRATULATIONS

You have just purchased the best electric shopping cart on the market today. The models #02002 and #01001 incorporate the very latest in technological advances. To assure you of the best and safest performance as well as longest life, please read the enclosed information.

After reading this manual, should you have a service problem or need help, please call our customer service department with the serial number of your cart, at our toll free number: (800) 548-3373 or (479) 636-5776.

**TO ORDER PARTS CALL: (479) 636-5776 OR (800) 548-3373**

Be sure to give the serial number to the service department personnel. This number is located on the rear body of the Mart Cart as shown in Figure #3 of this manual. The MARTIMATE and Mart Shopper serial number is located on the seat support tube under the seat.

**TERMS:** All parts will be shipped with check in advance or C.O.D. Commercial accounts are allowed 15 day terms from date on invoice with approved credit.

**FREIGHT:** All freight will be paid by the customer. Special consideration will be given to items under warranty coverage.

**IMPORTANT DOCUMENT — DO NOT DISCARD**

Serial Number:

Dated Shipped:

FRIEND'S  
DEFENDANT'S  
EXHIBIT  
**P**

**TABLE OF CONTENTS**

Warranty..... Pg. 2  
 Warnings..... Pg. 3  
 Recommended Operating Procedures..... Pg. 3  
 Freight Damage..... Pg. 3  
 Attention..... Pg. 3  
 Daily Maintenance Check List..... Pg. 4  
 Battery Charging..... Pg. 4  
 Battery Condition Test..... Pg. 5  
 Battery Replacement..... Pg. 5  
 Seat Lock and Chair Support Tube Lock..... Pg. 5  
 Seal Switch..... Pg. 5  
 Throttle Linkage Replacement..... Pg. 6  
 Throttle Grip Assembly..... Pg. 7  
 Cord Reel (Mart Cart)..... Pg. 7  
 Variable Speed Control..... Pg. 7  
 Motor Maintenance..... Pg. 8

**Notes:**

Foot Brake (Mart Cart)..... Pg. 8  
 Drive Belt..... Pg. 8  
 Circuit Breaker..... Pg. 8  
 Charging..... Pg. 8  
 Control Box..... Pg. 8  
 Mart Cart Exploded View..... Pg. 9  
 Mart Cart Wiring Diagram..... Pg. 10  
 Mart Cart Labels..... Pg. 11  
 MARTIMATE Exploded View..... Pg. 12  
 MARTIMATE Wiring Diagram..... Pg. 13  
 MARTIMATE Labels..... Pg. 14  
 Mart Shopper Exploded View..... Pg. 15  
 Mart Shopper Wiring Diagram..... Pg. 16  
 Mart Shopper Labels..... Pg. 17  
 Trouble Shooting..... Pg. 18  
 Notes..... Pg. 19

**LIMITED WARRANTY**

**For the Mart Cart, MAKIMATE and Mart Shopper**

- A. Parts:** one-year warranty from date of shipment. Battery is warranted for twelve months from date of shipment.
- B. Batteries:** Replacement batteries carry a six-month warranty. Must provide serial # of cart.
- C. Labor:** one-year limited warranty.

**Parts-Limited Warranty**—All parts, except cord reel, circuit breakers needing resetting, and broken keys in switches, are warranted by the manufacturer to be free from defects in material and workmanship for a period of one year from date of shipment. This warranty does not include wear and tear caused by above normal usage, abuse, negligence, freight damage, or damage caused by improper use or care, or by outside sources such as fire, floods, etc.

Should any component fail (except those mentioned) during the first year of ownership, return component in question to the manufacturer or authorized representative for inspection. If component has failed due to defect in material or workmanship, it will be exchanged or repaired at the manufacturer's discretion at no charge to the owner.

**Labor**—The manufacturer will cover labor charges for work performed in the field for one full year from the date of shipment as a result of defect in materials and workmanship. Charges incurred for resetting the circuitbreaker are exempted. Double service calls due to improper first call service or lack of repair parts are exempted.

The above warranties exclude shipping, handling, or travel expenses incurred for the repair of said cart or parts as well as items worn out through normal use whose malfunction is not attributable to defect.

For more information, contact us at (800) 548-3373 or visit our website at [www.makimate.com](http://www.makimate.com)

# — Important Safety Instructions —

## Please read before operating

### WARNINGS

- Never attempt to charge the battery in this cart without using an electrical outlet that is protected by a GFCI, (Ground Fault Circuit Interrupter).
- Replace complete cord reel if either it or the charging cord or plug is damaged or if the cord is worn or frayed.
- Never use the charging cord without proper grounding. Do not use it plug does not have three terminals.
- Never allow the cart to be used out-of-doors or on any surface that is not level
- Always disconnect power before servicing.
- See page 4 "Daily Maintenance Checklist" and follow instructions.

### RECOMMENDED OPERATING PROCEDURES

- This cart is for use indoors on level surface only
- Standing on cart is permitted providing the operator stands in the center only. **DO NOT STAND WHILE CART IS MOVING.** Be certain all switches are in the "OFF" position before standing. (See "Operating & Warning Instructions" on cart).
- After battery is charged, disconnect power supply cord before operating cart.
- DO NOT exceed the load limitations as shown on the cart.
- DO NOT force power supply cord into the rear housing of cart. Follow posted operating instructions.
- DO NOT allow children to operate or play on cart. Keep cart secured with key at service counter or offer "Key Club" program (see back cover).

### FREIGHT DAMAGE

- CHECK:**
- The shipping carton for any visible damage. Report the damage to the freight carrier immediately. File a claim with the carrier if actual damage to your cart has occurred.
  - Contents of the carton. The contents should agree with the information listed on the packing list. Report any discrepancy to the carrier and the factory immediately.

### ATTENTION

- It is the responsibility of the owner of this cart to maintain the cart in a safe and reliable operating condition at all times.

### TROUBLE SHOOTING

**Caution:** Well socket (electrical outlet) used for battery charging should have a ground fault circuit interrupter installed by a licensed electrician.

**Tools required:** Screwdrivers—blade & Phillips; socket set — 7/16", 1/2", 9/16", 3/8", 1/2", 5/16", 3/16", 3/32", 1/8", 5/32", 3/16", small crescent wrench, vice-grips, adjustable wrench, nut and socket; electric drill and bits, wire cutters, pliers; voltmeter; multi-meter; continuity checker; spray cleaner (Appearance magic for counter tops & plastics); clean rags; best lubricant, heavy duty grease.

- Charger must be unplugged to perform most tests. Power light, "FWD" or "REV" lights, and red bar light will work when charger is plugged in, but array of battery indicator lights will not work.
- To confirm motor and PWM controller operation, block the drive wheel off the floor and actuate the throttle while connecting a jumper wire from chassis ground to the green (FWD) or white (REV) wire at the PWM controller (Separate connector). If wheel turns but cart would not operate in normal fashion, above components are OK, but circuit board is suspect.
- To check battery (Charge for 6 hours minimum before hand), block drive wheel off floor, connect volt-ohm meter to battery, and actuate throttle at full speed. Reading should be 10.5 volts or higher.

| Symptoms   | Possible Cause   | What To Do  |
|--|--|---|
| 1. Cart won't go with good battery pack in "FWD" or "REV" when actuating throttle.           | 1. Open or weak electrical supply or broken bridge<br>2. Bad or worn battery<br>3. Bad or worn motor<br>4. Improper adjustment of potentiometer.<br>5. Bad SERVICE BOARD | 1. Replace bridge bridge<br>2. Adjust potentiometer<br>3. Adjust per instructions<br>4. Replace SERVICE BOARD<br>5. Check battery   |
| 2. Cart won't roll when rolling disk or set bar.   | 1. Loose wheel or axle<br>2. Loose axle or wheel<br>3. Loose axle or wheel<br>4. Loose axle or wheel<br>5. Loose axle or wheel   | 1. Tighten wheel<br>2. Tighten axle<br>3. Tighten axle<br>4. Tighten axle<br>5. Tighten axle  |
| 3. Cart won't go at all, throttle system OK.   | 1. Loose wheel or axle<br>2. Loose axle or wheel<br>3. Loose axle or wheel<br>4. Loose axle or wheel<br>5. Loose axle or wheel   | 1. Tighten wheel<br>2. Tighten axle<br>3. Tighten axle<br>4. Tighten axle<br>5. Tighten axle  |
| 4. Cart won't go or moves intermittently in "FWD" or "REV" when actuating throttle.          | 1. Loose wheel or axle<br>2. Loose axle or wheel<br>3. Loose axle or wheel<br>4. Loose axle or wheel<br>5. Loose axle or wheel   | 1. Tighten wheel<br>2. Tighten axle<br>3. Tighten axle<br>4. Tighten axle<br>5. Tighten axle  |
| 5. Cart goes but only at high speed when throttle is set to "REV" or "FWD".                  | 1. Throttle spring broken<br>2. Throttle potentiometer<br>3. Throttle potentiometer<br>4. Throttle potentiometer<br>5. Throttle potentiometer                            | 1. Replace potentiometer<br>2. Replace potentiometer<br>3. Replace potentiometer<br>4. Replace potentiometer<br>5. Replace potentiometer                                    |
| 6. Motor won't turn or charges, cart does not start through charging line charging at night. | 1. Motor not connected<br>2. Motor not connected<br>3. Motor not connected<br>4. Motor not connected<br>5. Motor not connected   | 1. Connect motor<br>2. Connect motor<br>3. Connect motor<br>4. Connect motor<br>5. Connect motor  |
| 7. Cart won't go or only at low speed for short duration with above conditions ruled out.    | 1. Tire rubbing on body<br>2. Tire rubbing on body<br>3. Tire rubbing on body<br>4. Tire rubbing on body<br>5. Tire rubbing on body                                      | 1. Check wheel bearings or axle<br>2. Check wheel bearings or axle<br>3. Check wheel bearings or axle<br>4. Check wheel bearings or axle<br>5. Check wheel bearings or axle |
| 8. Cart won't go or moves intermittently in "FWD" or "REV" when actuating throttle.          | 1. Loose wheel or axle<br>2. Loose axle or wheel<br>3. Loose axle or wheel<br>4. Loose axle or wheel<br>5. Loose axle or wheel   | 1. Tighten wheel<br>2. Tighten axle<br>3. Tighten axle<br>4. Tighten axle<br>5. Tighten axle  |
| 9. Cart won't go or operates in only "FWD" or only "REV" when actuating throttle.            | 1. Loose wheel or axle<br>2. Loose axle or wheel<br>3. Loose axle or wheel<br>4. Loose axle or wheel<br>5. Loose axle or wheel   | 1. Tighten wheel<br>2. Tighten axle<br>3. Tighten axle<br>4. Tighten axle<br>5. Tighten axle  |
| 10. Battery controller LED won't operate.  | 1. Loose wiring<br>2. Loose wiring<br>3. Loose wiring<br>4. Loose wiring<br>5. Loose wiring  | 1. Tighten wiring<br>2. Tighten wiring<br>3. Tighten wiring<br>4. Tighten wiring<br>5. Tighten wiring   |
| 11. Cart won't start when plugged in.  | 1. Loose wheel or axle<br>2. Loose axle or wheel<br>3. Loose axle or wheel<br>4. Loose axle or wheel<br>5. Loose axle or wheel   | 1. Tighten wheel<br>2. Tighten axle<br>3. Tighten axle<br>4. Tighten axle<br>5. Tighten axle  |
| 12. Cart moves when cart is plugged in.  | 1. Loose wheel or axle<br>2. Loose axle or wheel<br>3. Loose axle or wheel<br>4. Loose axle or wheel<br>5. Loose axle or wheel   | 1. Tighten wheel<br>2. Tighten axle<br>3. Tighten axle<br>4. Tighten axle<br>5. Tighten axle  |
| 13. Cart won't go or operates in only "FWD" or only "REV" when actuating throttle.           | 1. Loose wheel or axle<br>2. Loose axle or wheel<br>3. Loose axle or wheel<br>4. Loose axle or wheel<br>5. Loose axle or wheel   | 1. Tighten wheel<br>2. Tighten axle<br>3. Tighten axle<br>4. Tighten axle<br>5. Tighten axle  |
| 14. Cart won't go or operates in only "FWD" or only "REV" when actuating throttle.           | 1. Loose wheel or axle<br>2. Loose axle or wheel<br>3. Loose axle or wheel<br>4. Loose axle or wheel<br>5. Loose axle or wheel   | 1. Tighten wheel<br>2. Tighten axle<br>3. Tighten axle<br>4. Tighten axle<br>5. Tighten axle  |
| 15. Cart won't go or operates in only "FWD" or only "REV" when actuating throttle.           | 1. Loose wheel or axle<br>2. Loose axle or wheel<br>3. Loose axle or wheel<br>4. Loose axle or wheel<br>5. Loose axle or wheel   | 1. Tighten wheel<br>2. Tighten axle<br>3. Tighten axle<br>4. Tighten axle<br>5. Tighten axle  |



**DAILY MAINTENANCE CHECK LIST**

- For optimum cart availability and performance, the following items should be checked daily:
  - **ELECTRIC CORD and/or REEL**—Replace cord reel if cord is worn or frayed. 3 pronged plug is broken or reel will not retract. Be sure power outlet provides protection through an operating "Ground Fault Circuit Interrupter" (GFCI).
  - **SEAT AND MOUNTING**—Tighten if necessary. If cracks or rust occur, or if seat rocks loosely, replace at once. Lubricate tracks with Vaseline as required. Make sure Seat Lock is in good working condition.
  - **SEAT SWITCH**—Test and replace if not working properly. Cart must stop when weight is removed from seat.
  - **THRUSTLE**—Test for smooth "start, acceleration, deceleration, and stop." Repair if necessary. Charge or replace battery if needed.
  - **ANTI-TIP CASTERS**—Replaces if broken. Maintain height adjustment of 3/8" to 1/2" above floor level.
  - **BRAKES**—Test to be sure cart stops.
  - **GENERAL**—Repair or replace any component that would cause a potential safety hazard.
  - **APPEARANCE**—Wipe off and clean as needed for customer satisfaction and for stores public image.

**BATTERY CHARGING**

- Install a Ground Fault circuit interrupter (GFCI) in the electrical circuit wherever the cart is to be charged. This is to protect against any possible shock hazard.
- AC voltage required is 120V AC. The current draw is 1.5 amps. The charger output will be below 6 amps, DC, to the battery.
- Charge battery nightly after daily use. When the battery is fully charged, the charger will maintain a "float voltage" which will not damage the battery.
- One complete charge will allow up to 5 days of normal grocery operation before battery is completely discharged. A fully discharged battery will take 20 hours to fully charge, so it is best not let the battery become completely discharged.
- Do not store the cart with a discharged battery for more than 30 days, as this can cause premature battery failure. Fully charge the battery at least every 30 days, if in a low usage location.
- To determine if the charger is working properly, remove the rear cover, plug the charger into a GFCI protected line. The Charger light should be yellow, if charging, and green if the battery indicates fully charged. The red light indicates the charger is plugged in.
- No maintenance of battery is required. The battery is maintenance free, and water cannot be added.

**Note:** Under normal conditions, the battery will last 18 months or longer if the above recommendations are followed. Replace with only original Mart Cart Battery. Mart Cart is not responsible for any adverse effects caused by replacement with any other type of battery.

**MART SHOPPER LABELS**

• Replace labels if Damaged, Lost or Unreadable!

**MART Shopper**  
By **mart** 1-800-548-3373, 501-636-5776, www.martcart.com

**MART Shopper**  
500-5-8-3373



USE CHARGER ON LINE SOURCE ONLY. DO NOT REMOVE FROM STORE.

**BATTERY CHARGER**  
120 VOLTS-INPUT-1.5 AMPS  
RECOMMENDED CHARGE CYCLE  
NOT TO EXCEED 16 HOURS  
DISCONNECT  
BEFORE OPERATING CART



**DAILY MAINTENANCE CHECK LIST**  
For safety and performance, use following items for daily maintenance:

1. **SEAT AND MOUNTING**—Tighten if necessary. If cracks or rust occur, or if seat rocks loosely, replace at once. Lubricate tracks with Vaseline as required. Make sure Seat Lock is in good working condition.
2. **SEAT SWITCH**—Test and replace if not working properly. Cart must stop when weight is removed from seat.
3. **THRUSTLE**—Test for smooth "start, acceleration, deceleration, and stop." Repair if necessary. Charge or replace battery if needed.
4. **ANTI-TIP CASTERS**—Replaces if broken. Maintain height adjustment of 3/8" to 1/2" above floor level.
5. **BRAKES**—Test to be sure cart stops.
6. **GENERAL**—Repair or replace any component that would cause a potential safety hazard.
7. **APPEARANCE**—Wipe off and clean as needed for customer satisfaction and for stores public image.

**WARNING**  
FOR INDOOR USE ONLY  
TO PREVENT PERSONAL INJURY FROM ELECTRICAL SHOCK - DO NOT USE CHARGING CORD IN A GROUND FAULT CIRCUIT INTERRUPTER (GFCI) OR A GROUND FAULT CIRCUIT INTERRUPTER (GFCI) PROTECTED LINE. THE CHARGER LIGHT SHOULD BE YELLOW, IF CHARGING, AND GREEN IF THE BATTERY INDICATES FULLY CHARGED. THE RED LIGHT INDICATES THE CHARGER IS PLUGGED IN.

**OPERATING INSTRUCTIONS**  
PLEASE READ BEFORE OPERATING

1. ALWAYS WEAR YOUR SEATBELT AND HOLD ON TO THE SEAT. NEVER LEAVE THE CART UNATTENDED.
2. ALWAYS WEAR YOUR SEATBELT AND HOLD ON TO THE SEAT. NEVER LEAVE THE CART UNATTENDED.
3. ALWAYS WEAR YOUR SEATBELT AND HOLD ON TO THE SEAT. NEVER LEAVE THE CART UNATTENDED.
4. ALWAYS WEAR YOUR SEATBELT AND HOLD ON TO THE SEAT. NEVER LEAVE THE CART UNATTENDED.
5. ALWAYS WEAR YOUR SEATBELT AND HOLD ON TO THE SEAT. NEVER LEAVE THE CART UNATTENDED.
6. ALWAYS WEAR YOUR SEATBELT AND HOLD ON TO THE SEAT. NEVER LEAVE THE CART UNATTENDED.
7. ALWAYS WEAR YOUR SEATBELT AND HOLD ON TO THE SEAT. NEVER LEAVE THE CART UNATTENDED.

**WARNING**  
PLEASE READ TO AVOID PERSONAL INJURY

1. ALWAYS WEAR YOUR SEATBELT AND HOLD ON TO THE SEAT. NEVER LEAVE THE CART UNATTENDED.
2. ALWAYS WEAR YOUR SEATBELT AND HOLD ON TO THE SEAT. NEVER LEAVE THE CART UNATTENDED.
3. ALWAYS WEAR YOUR SEATBELT AND HOLD ON TO THE SEAT. NEVER LEAVE THE CART UNATTENDED.
4. ALWAYS WEAR YOUR SEATBELT AND HOLD ON TO THE SEAT. NEVER LEAVE THE CART UNATTENDED.
5. ALWAYS WEAR YOUR SEATBELT AND HOLD ON TO THE SEAT. NEVER LEAVE THE CART UNATTENDED.
6. ALWAYS WEAR YOUR SEATBELT AND HOLD ON TO THE SEAT. NEVER LEAVE THE CART UNATTENDED.
7. ALWAYS WEAR YOUR SEATBELT AND HOLD ON TO THE SEAT. NEVER LEAVE THE CART UNATTENDED.

Note: All labels on this page are not to scale.

**MART SHOPPER WIRING DIAGRAM**

**FIGURE 8**  
MC-01001-MS PICTORIAL WIRING DIAGRAM

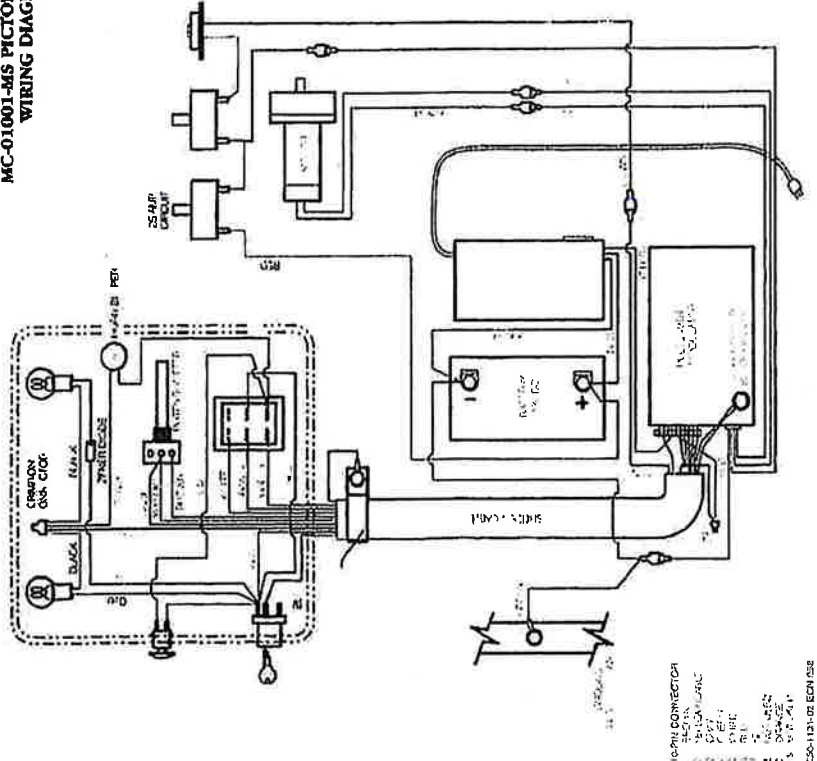

1. GREEN  
2. RED  
3. BLACK  
4. WHITE  
5. BLUE  
25A-13-02 EOM 038

**BATTERY CONDITION TEST**

**Mart Cart and MARTMATE**

Read The Light Bar Display Under Load.

- A true indication of battery level can be seen on light bar display when accelerating cart to full speed.
- To test the battery, sit on cart seat, turn on the key switch, place soft touch switch in forward, twist throttle grip fully on.

**MART SHOPPER**

To test the battery condition of the Mart Shopper, sit on cart to activate the seat switch, turn the key switch to the on position, select Neutral by placing the FWD/REW switch in the middle position, and twist the throttle fully on. If the green light does not come on, recharge battery.

**IMPORTANT:** Your cart has been equipped with a gel-cell battery during the manufacturing process as original equipment. The manufacturer recommends that you replace the original battery only with the same type and rating to prevent damage to your cart's internal components, charging system, or personal injury to you and your customer.

**BATTERY REPLACEMENT**

• Be Responsible: Recycle old battery or dispose of according to local or national codes.

To Replace Battery: (Read precautions on battery-avoid any sparks)

1. Turn off key switch and remove key. Disconnect charger cord from wall outlet, if plugged in.
  2. For MARTMATE and Mart Shopper pull chair release at base of support tubes and swing chair back-wards. Lift rear housing cover off cart. For Mart Carts, remove rear cover by removing S.S. screw or knob in front of cover and twisting the two locking tabs under the back and rear side of the cart frame. Disconnect seat switch wires if necessary.
  3. Remove tie down strap from battery.
  4. Disconnect the negative and positive wire bundles from the two battery posts and remove the battery.
- CAUTION: Do not cross battery posts with metal object!**
5. Install new battery with the negative post (-) towards the left front of cart-furthest away from the drive wheel. Connect the red leads to the positive post (+) first. Connect the black leads to the negative post (-). Reposition protective cover over positive post.
  6. Connect the red leads to the positive post (+) first. Connect the black leads to the negative post (-). Reposition protective cover over positive post.
  7. Secure battery with rubber strap (Check condition of strap and replace if necessary), or hold down bracket.
  8. Before reinstalling cover, check wheel condition, belt condition and tension, and general condition of other components.
  9. Reinstall rear cover, and chair, making certain the chair support tubes are securely latched on the MART-MATE and Mart Shopper and front and rear fastening is accomplished on Mart Cart rear cover. Make sure seat switch wires are connected.
  10. Test cart for proper operation. Charge battery if necessary.

**SEAT LOCK & CHAIR SUPPORT TUBE LOCK**

**MARTMATE & Mart Shopper**

- The seat lock and the chair support tube lock should be inspected daily for proper function. The release/locking arm should move freely and spring back into locking position. If return function is broken, **DO NOT USE** cart until spring is replaced.

**SEAT SWITCH**

- The seat switch is located under seat. Pressure (Weight) on the seat closes the control circuit, and allows the cart to operate.

**THROTTLE LINKAGE REPLACEMENT**

**For the Mart Cart, MARKIMATE and Mart Shopper**

1. Turn off key switch.
2. Remove control box cover. Refer to figure #1. Examine linkage, adjust or replace as necessary.
3. To free the ball end of the linkage, the inner throttle tube (See Figure #2) must be related towards the front of the cart. This may be done by removing the upper and lower clamp halves.
4. Rotate the inner throttle tube forward until the ball end of the linkage is visible and removable.
5. Disconnect the other end of the linkage from the throttle plate. (Figure #1)
6. Install new linkage by inserting ball end into hole and slot of inner throttle tube. Be certain cable is in slot. Hold hand tension on cable while rotating throttle grip backwards so as to spool up linkage around inner throttle tube. The linkage should wrap around inner throttle tube about 3/4 turn.
7. Re-install clamp halves on throttle grip. Be certain that flat handles on grips are parallel to control box mounting plate.
8. Attach other end of linkage to throttle plate. Secure with flatwashers and "E" ring.
9. Twist the throttle grip to test the throttle actuation and security of the linkage to the inner throttle tube and throttle.
10. Turn on key switch and test cart for proper operation. The motor circuit should be activated after an approximate 35-40 degree twist of the grip.
11. The potentiometer may require resetting for accurate throttle response. This may be accomplished by loosening the set screw in collar of throttle plate, it should be adjusted to allow the throttle grip to rise 35-40 degrees before the motor circuit is activated. Test throttle linkage with throttle in full "ON" position. The cable should still be able to be depressed slightly. (This assures that the potentiometer is not in danger of breaking its internal stop). Make sure cart stops when throttle is released.
12. After final inspection, reassemble the control box, being sure that all wires are tucked up and out of the way of the new throttle linkage.

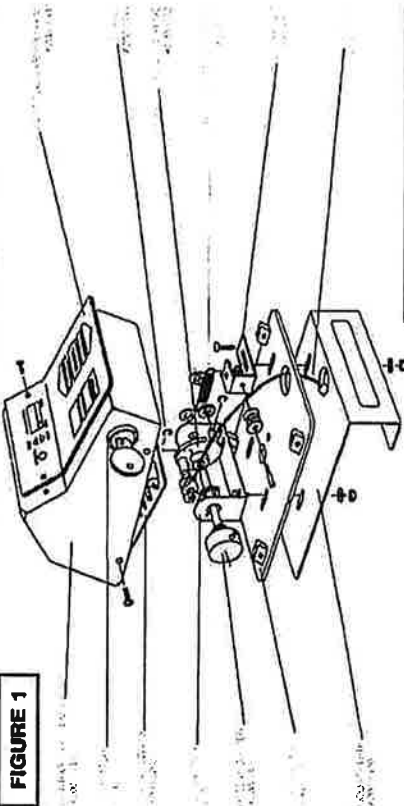

**FIGURE 1**

**IMPORTANT: Check Throttle Return Spring for wear...replace if worn.**

Mart Cart & MARKIMATE

**MART SHOPPER EXPLODED VIEW**

**FIGURE 7**

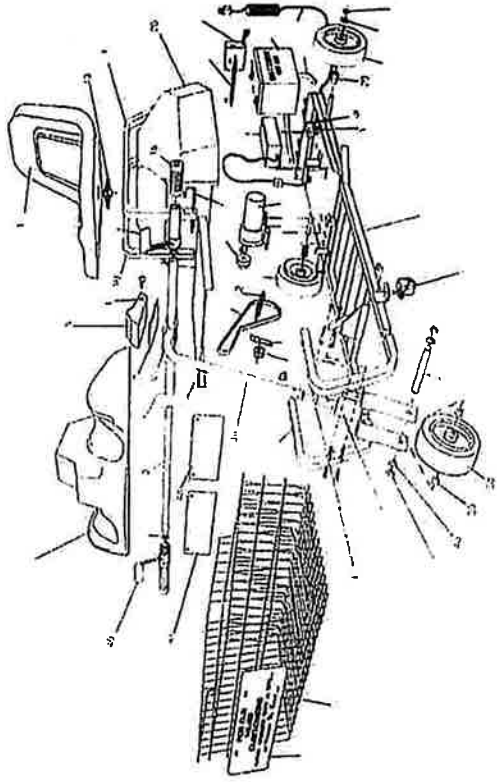

| Item # | Part #   | Description         | Quantity |
|--------|----------|---------------------|----------|
| 1      | 100-1234 | Front Fork          | 1        |
| 2      | 100-1235 | Front Wheel         | 1        |
| 3      | 100-1236 | Front Tire          | 1        |
| 4      | 100-1237 | Front Hub           | 1        |
| 5      | 100-1238 | Front Brake         | 1        |
| 6      | 100-1239 | Front Axle          | 1        |
| 7      | 100-1240 | Front Suspension    | 1        |
| 8      | 100-1241 | Front Shock         | 1        |
| 9      | 100-1242 | Front Spring        | 1        |
| 10     | 100-1243 | Front Fender        | 1        |
| 11     | 100-1244 | Front Light         | 1        |
| 12     | 100-1245 | Front Horn          | 1        |
| 13     | 100-1246 | Front Bumper        | 1        |
| 14     | 100-1247 | Front License Plate | 1        |
| 15     | 100-1248 | Front Mudguard      | 1        |
| 16     | 100-1249 | Front Wheel Nut     | 1        |
| 17     | 100-1250 | Front Wheel Washer  | 1        |
| 18     | 100-1251 | Front Wheel Seal    | 1        |
| 19     | 100-1252 | Front Wheel Cap     | 1        |
| 20     | 100-1253 | Front Wheel Lock    | 1        |



**MARTIMATE Labels** • Replace labels if Damaged, Lost or Unreadable!

**MARTIMATE**  
By **mart cart** 1-800-548-3373, 501-636-5776, www.martcart.com

**MARTIMATE**  
800-548-3373



**CHARGER INFORMATION**  
Charge each day for maximum of 8 hours. Do not exceed 16 hours.



**BATTERY CHARGER**  
120 VOLTS-INPUT-1.5 AMPS  
RECOMMENDED CHARGE CYCLE  
NOT TO EXCEED 16 HOURS  
DISCONNECT  
BEFORE OPERATING CART

BE KEPT IN LIME SURFACE WILL  
DO NOT EXCEED 100 LBS.



**WARNING**  
FOR INDOOR USE ONLY  
TO PREVENT PERSONAL INJURY FROM ELECTRICAL SHOCK - DO NOT TOUCH CHARGER CORDS OR PLUGS. ALWAYS UNPLUG CHARGER FROM WALL OUTLET BEFORE OPERATING CART.  
IF THE ELECTRICAL CORD OR PLUG IS DAMAGED OR WORN, REPLACE BEFORE USING WITH ONLY 3 WIRE CORD AND PLUG OF SAME TYPE.

**DAILY MAINTENANCE CHECK LIST**  
Check the following items daily and perform them as indicated:  
1. **FLUIDS:** Check oil level. Add oil if needed. Check coolant level. Add coolant if needed. Check brake fluid level. Add brake fluid if needed. Check washer fluid level. Add washer fluid if needed.  
2. **TIRE PRESSURE:** Check tire pressure. Add air if needed. Check tire tread. Replace tire if needed.  
3. **WHEELS:** Check wheel alignment. Adjust if needed. Check wheel bearings. Lubricate if needed.  
4. **STEERING:** Check steering. Adjust if needed. Check steering rack. Lubricate if needed.  
5. **SAFETY:** Check seat belt. Adjust if needed. Check safety harness. Adjust if needed.  
6. **GENERAL:** Check for leaks. Check for damage. Check for loose parts. Tighten if needed.  
FOR PARTS OR SERVICE CALL  
800-548-3373 or 501-636-5776

**OPERATING INSTRUCTIONS**  
PLEASE READ BEFORE OPERATING  
1. ALWAYS WEAR YOUR SEAT BELT AND SAFETY HARNESS. DO NOT OPERATE THE CART WITHOUT WEARING YOUR SEAT BELT AND SAFETY HARNESS.  
2. ALWAYS WEAR YOUR SAFETY GLASSES.  
3. ALWAYS WEAR YOUR HEARING PROTECTION.  
4. ALWAYS WEAR YOUR PROTECTIVE FOOTWEAR.  
5. ALWAYS WEAR YOUR PROTECTIVE CLOTHING.  
6. ALWAYS WEAR YOUR PROTECTIVE GLOVES.  
7. ALWAYS WEAR YOUR PROTECTIVE MASK.

**WARNING**  
PLEASE READ TO AVOID PERSONAL INJURY  
1. ALWAYS WEAR YOUR SEAT BELT AND SAFETY HARNESS. DO NOT OPERATE THE CART WITHOUT WEARING YOUR SEAT BELT AND SAFETY HARNESS.  
2. ALWAYS WEAR YOUR SAFETY GLASSES.  
3. ALWAYS WEAR YOUR HEARING PROTECTION.  
4. ALWAYS WEAR YOUR PROTECTIVE FOOTWEAR.  
5. ALWAYS WEAR YOUR PROTECTIVE CLOTHING.  
6. ALWAYS WEAR YOUR PROTECTIVE GLOVES.  
7. ALWAYS WEAR YOUR PROTECTIVE MASK.

**THROTTLE GRIP ASSEMBLY**

For the Mart Cart, MARTIMATE  
and Mart Shopper

FIGURE 2

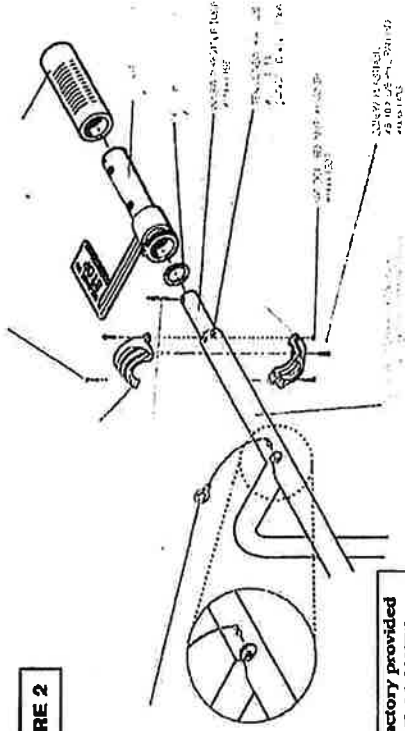

Use factory provided  
plastatron screws

**CORD REEL (MART CART)**

- The cord reel is provided as a convenient tool for recharging your cart on a regular basis. When not in use, the cord is safely tucked away out of sight.
- The cord reel will give you years of trouble-free service providing the simple operating instructions posted on the cart are followed. (See "Recommended Operating Procedures".)
- Cord reel failures are due mostly to abuse. Two common abuses are: tugging on cord to pull plug from outlet, and not allowing reel to retract the cord. Inspect daily the condition of cord, plug and reel. Replace if necessary.

**IMPORTANT:** A Ground Fault Interrupter (GFCI) should be used in your stores electrical outlet where you intend to draw current to charge your cart.

**VARIABLE SPEED CONTROL**

- The cart's speed is regulated by a potentiometer. This provides extremely smooth acceleration from 0 to 1.9 MPH, and is located in the control box on the steering column.

Note: All labels on this page are not to scale.

**MOTOR MAINTENANCE**

- There is no scheduled maintenance required. However, when the rear cover of the cart is removed for other reasons (Such as battery replacement) the motor should be examined.
- What to look for: Check the belt tension, check for any motor shaft seal leakage, check the motor mounts, check the brushes at least once every 5 years.
- Motor brushes-there are two brushes at the rear end of the motor. They are each located inside a small round plastic housing. A small screwdriver may be used to back out each brush. If the motor stops running, check the brushes.

**FOOT BRAKE (MART CART)**

- The Foot Brake should be tried daily for proper operation. Repair or replace any damaged or worn parts.

**DRIVE BELT**

- Check for belt alignment between drive and wheel pulleys. Belt should run true with no side misalignment and should also be centered over tension idler pulley.
- The belt tension idler provides automatic belt tensioning; however, it must be initially set so that the belt has a deflection of 1/2" to 3/4".
- To increase idler tension, re-hook spring into the next further chain link.

**CIRCUIT BREAKER**

- The circuit breaker is designed to protect your electrical system from transient overloads or electrical shorts. Either could cause serious damage without a circuit breaker to open the circuit.
- The circuit breakers are a manual reset type, and are rated at 5 and 25 amps. Each requires manual resetting once it has been tripped. They are located underneath the seat on the right hand side of the Mart Cart. On the MARTMATE and Mart Shopper they are found underneath the left rear corner and can be reached by hand from outside the cart.

**CHARGING**

- **HOW IT WORKS:** When the power supply cord is plugged into the stores electrical outlet the battery charger is energized. The charger sends approximately 14.5 volts to battery for charging. A third wire (Yellow) from the charger output inhibits the PWM until the power to the charger is disconnected. The motor circuit is interrupted until charging is complete.
- **CHARGING:** The cart will not move under power when the battery is being charged. If the cart moves while plugged in, check the power to your outlet before calling for service.

**CONTROL BOX**

- The master control box for the Mart Cart and MARTMATE is located on top of the steering column. It contains the "Forward, Neutral, Reverse" switch pad, battery condition indicator, horn and key switch (key switch optional).
- The cover can be removed by removing the four side screws. The control circuit board can be replaced if necessary.
- The master control for the Mart Shopper is also located on top of the steering column. It contains the "Forward, Neutral, Reverse" rocker switch, battery condition indicator, horn and key switch.

**MARTMATE WIRING DIAGRAM**

**FIGURE 6**

**MM-01001 PICTORIAL WIRING DIAGRAM**

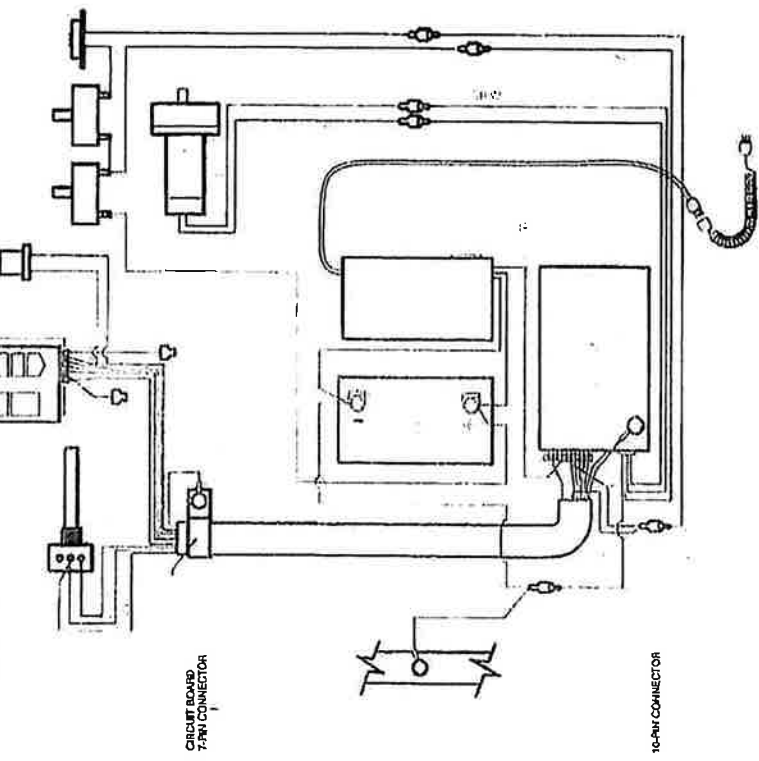

View of circuit is provided with the Daxx System. Please contact the Daxx System at 1-800-555-5555 for more information.



**MARTMATE EXPLODED VIEW**

**FIGURE 5**

280-3312-01 ECN 076

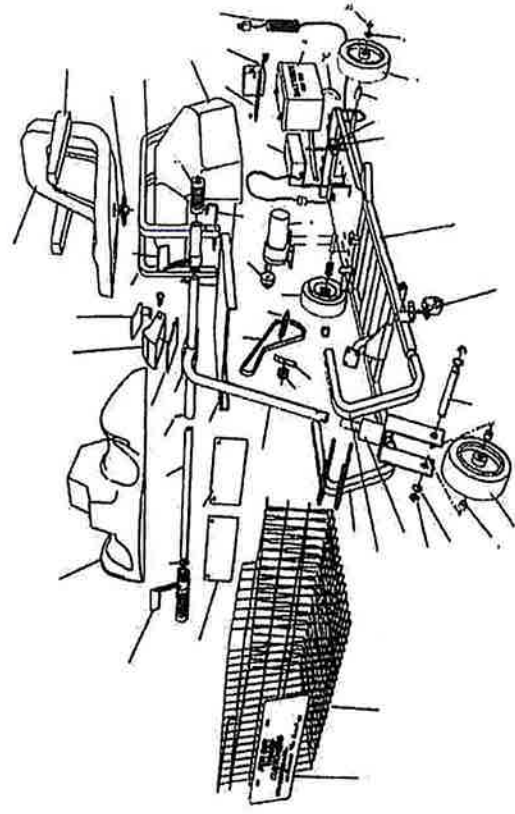

| Item | Part #   | Description    | Part # | Description    |
|------|----------|----------------|--------|----------------|
| 10   | 280-1114 | Cart Body      | 10     | Cart Body      |
| 20   | 280-1099 | Drive Motor    | 11     | Drive Motor    |
| 21   | 280-1028 | Motor Mount    | 12     | Motor Mount    |
| 22   | 280-1029 | Motor Cover    | 13     | Motor Cover    |
| 23   | 280-1024 | Frame, CH-24   | 14     | Frame, CH-24   |
| 24   | 280-1025 | Cart Head      | 15     | Cart Head      |
| 25   | 280-1026 | Barrel 24 x 24 | 16     | Barrel 24 x 24 |
| 26   | 280-1027 | Barrel 24 x 24 | 17     | Barrel 24 x 24 |
| 27   | 280-1028 | Barrel 24 x 24 | 18     | Barrel 24 x 24 |
| 28   | 280-1029 | Barrel 24 x 24 | 19     | Barrel 24 x 24 |
| 29   | 280-1030 | Barrel 24 x 24 | 20     | Barrel 24 x 24 |
| 30   | 280-1031 | Barrel 24 x 24 | 21     | Barrel 24 x 24 |
| 31   | 280-1032 | Barrel 24 x 24 | 22     | Barrel 24 x 24 |
| 32   | 280-1033 | Barrel 24 x 24 | 23     | Barrel 24 x 24 |
| 33   | 280-1034 | Barrel 24 x 24 | 24     | Barrel 24 x 24 |
| 34   | 280-1035 | Barrel 24 x 24 | 25     | Barrel 24 x 24 |
| 35   | 280-1036 | Barrel 24 x 24 | 26     | Barrel 24 x 24 |

**MART CART EXPLODED VIEW**

**FIGURE 3**

200-2020-02 ECN 075

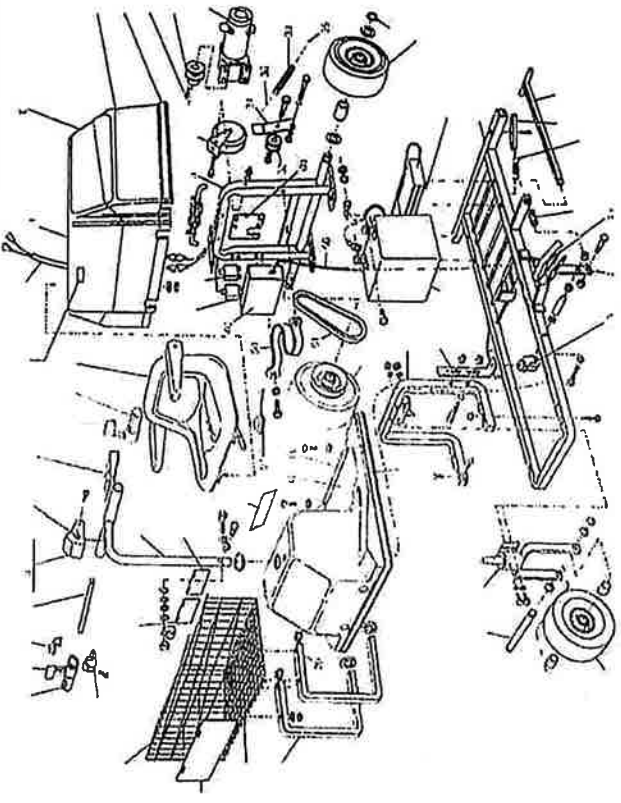

| Item | Part #   | Description    | Part # | Description    |
|------|----------|----------------|--------|----------------|
| 1    | 200-1001 | Cart Body      | 1      | Cart Body      |
| 2    | 200-1002 | Drive Motor    | 2      | Drive Motor    |
| 3    | 200-1003 | Motor Mount    | 3      | Motor Mount    |
| 4    | 200-1004 | Motor Cover    | 4      | Motor Cover    |
| 5    | 200-1005 | Frame, CH-24   | 5      | Frame, CH-24   |
| 6    | 200-1006 | Cart Head      | 6      | Cart Head      |
| 7    | 200-1007 | Barrel 24 x 24 | 7      | Barrel 24 x 24 |
| 8    | 200-1008 | Barrel 24 x 24 | 8      | Barrel 24 x 24 |
| 9    | 200-1009 | Barrel 24 x 24 | 9      | Barrel 24 x 24 |
| 10   | 200-1010 | Barrel 24 x 24 | 10     | Barrel 24 x 24 |
| 11   | 200-1011 | Barrel 24 x 24 | 11     | Barrel 24 x 24 |
| 12   | 200-1012 | Barrel 24 x 24 | 12     | Barrel 24 x 24 |
| 13   | 200-1013 | Barrel 24 x 24 | 13     | Barrel 24 x 24 |
| 14   | 200-1014 | Barrel 24 x 24 | 14     | Barrel 24 x 24 |
| 15   | 200-1015 | Barrel 24 x 24 | 15     | Barrel 24 x 24 |
| 16   | 200-1016 | Barrel 24 x 24 | 16     | Barrel 24 x 24 |
| 17   | 200-1017 | Barrel 24 x 24 | 17     | Barrel 24 x 24 |
| 18   | 200-1018 | Barrel 24 x 24 | 18     | Barrel 24 x 24 |
| 19   | 200-1019 | Barrel 24 x 24 | 19     | Barrel 24 x 24 |
| 20   | 200-1020 | Barrel 24 x 24 | 20     | Barrel 24 x 24 |

Replace labels if Damaged, Lost or Unreadable!

MART CART LABELS

**mart cart**  
1-800-548-3373 OR 1-501-636-5776

DO NOT REMOVE THIS LABEL FROM THE FRONT OF THE CART. IT IS A SAFETY LABEL. IT MUST REMAIN ON THE FRONT OF THE CART AT ALL TIMES.

DO NOT REMOVE THIS LABEL FROM THE FRONT OF THE CART. IT IS A SAFETY LABEL. IT MUST REMAIN ON THE FRONT OF THE CART AT ALL TIMES.

DO NOT REMOVE THIS LABEL FROM THE FRONT OF THE CART. IT IS A SAFETY LABEL. IT MUST REMAIN ON THE FRONT OF THE CART AT ALL TIMES.

DO NOT REMOVE THIS LABEL FROM THE FRONT OF THE CART. IT IS A SAFETY LABEL. IT MUST REMAIN ON THE FRONT OF THE CART AT ALL TIMES.

CAUTION HIGH VOLTAGE

CE

OPERATING INSTRUCTIONS

1. Turn on power with key.
2. Select "Forward" or "Reverse".
3. Hold up "SLOWLY" releases to STOP.
4. Release Cart.
5. Release All Releases in "OFF" position.
6. DO NOT REMOVE FRONT STYLING.

Use instructions on level surfaces only!

**DAILY MAINTENANCE CHECK LIST**  
For optimum Cart performance and performance, the following items should be checked for monthly ability:

1. BATTERY CHARGES - Fully charged battery should be used. A fully charged battery should be used. A fully charged battery should be used.
2. TIRE PRESSURE - Check tire pressure. Inflate to 30 PSI.
3. TIRE WEAR - Check tire wear. Replace tires if worn.
4. FLUIDS - Check oil level. Change oil if needed.
5. AIR FILTERS - Check air filter. Replace if dirty.
6. BELT TENSION - Check belt tension. Adjust if needed.
7. LIGHTS - Check lights. Replace if needed.
8. BRAKES - Check brakes. Adjust if needed.
9. SAFETY - Check safety. Adjust if needed.
10. GENERAL - Check general. Adjust if needed.

**WARNING**  
PLEASE READ TO AVOID PERSONAL INJURY

1. USE AT YOUR OWN RISK. READ CAREFULLY BEFORE OPERATING. IF YOU ARE NOT FAMILIAR WITH THIS CART, READ THE OPERATING INSTRUCTIONS CAREFULLY.
2. ALWAYS WEAR YOUR SEATBELT AND SAFETY BELT AT ALL TIMES. DO NOT OPERATE THE CART WITHOUT WEARING YOUR SEATBELT AND SAFETY BELT.
3. ALWAYS WEAR YOUR SAFETY BELT AND SAFETY BELT AT ALL TIMES. DO NOT OPERATE THE CART WITHOUT WEARING YOUR SEATBELT AND SAFETY BELT.
4. ALWAYS WEAR YOUR SAFETY BELT AND SAFETY BELT AT ALL TIMES. DO NOT OPERATE THE CART WITHOUT WEARING YOUR SEATBELT AND SAFETY BELT.
5. ALWAYS WEAR YOUR SAFETY BELT AND SAFETY BELT AT ALL TIMES. DO NOT OPERATE THE CART WITHOUT WEARING YOUR SEATBELT AND SAFETY BELT.
6. ALWAYS WEAR YOUR SAFETY BELT AND SAFETY BELT AT ALL TIMES. DO NOT OPERATE THE CART WITHOUT WEARING YOUR SEATBELT AND SAFETY BELT.
7. ALWAYS WEAR YOUR SAFETY BELT AND SAFETY BELT AT ALL TIMES. DO NOT OPERATE THE CART WITHOUT WEARING YOUR SEATBELT AND SAFETY BELT.
8. ALWAYS WEAR YOUR SAFETY BELT AND SAFETY BELT AT ALL TIMES. DO NOT OPERATE THE CART WITHOUT WEARING YOUR SEATBELT AND SAFETY BELT.
9. ALWAYS WEAR YOUR SAFETY BELT AND SAFETY BELT AT ALL TIMES. DO NOT OPERATE THE CART WITHOUT WEARING YOUR SEATBELT AND SAFETY BELT.
10. ALWAYS WEAR YOUR SAFETY BELT AND SAFETY BELT AT ALL TIMES. DO NOT OPERATE THE CART WITHOUT WEARING YOUR SEATBELT AND SAFETY BELT.

**WARNING**  
DO NOT REMOVE THIS LABEL FROM THE FRONT OF THE CART. IT IS A SAFETY LABEL. IT MUST REMAIN ON THE FRONT OF THE CART AT ALL TIMES.

**6 AMP BATTERY CHARGER**  
OPERATING INSTRUCTIONS  
PLEASE READ BEFORE OPERATING

1. ALWAYS WEAR YOUR SAFETY BELT AND SAFETY BELT AT ALL TIMES. DO NOT OPERATE THE CART WITHOUT WEARING YOUR SEATBELT AND SAFETY BELT.
2. ALWAYS WEAR YOUR SAFETY BELT AND SAFETY BELT AT ALL TIMES. DO NOT OPERATE THE CART WITHOUT WEARING YOUR SEATBELT AND SAFETY BELT.
3. ALWAYS WEAR YOUR SAFETY BELT AND SAFETY BELT AT ALL TIMES. DO NOT OPERATE THE CART WITHOUT WEARING YOUR SEATBELT AND SAFETY BELT.
4. ALWAYS WEAR YOUR SAFETY BELT AND SAFETY BELT AT ALL TIMES. DO NOT OPERATE THE CART WITHOUT WEARING YOUR SEATBELT AND SAFETY BELT.
5. ALWAYS WEAR YOUR SAFETY BELT AND SAFETY BELT AT ALL TIMES. DO NOT OPERATE THE CART WITHOUT WEARING YOUR SEATBELT AND SAFETY BELT.
6. ALWAYS WEAR YOUR SAFETY BELT AND SAFETY BELT AT ALL TIMES. DO NOT OPERATE THE CART WITHOUT WEARING YOUR SEATBELT AND SAFETY BELT.
7. ALWAYS WEAR YOUR SAFETY BELT AND SAFETY BELT AT ALL TIMES. DO NOT OPERATE THE CART WITHOUT WEARING YOUR SEATBELT AND SAFETY BELT.
8. ALWAYS WEAR YOUR SAFETY BELT AND SAFETY BELT AT ALL TIMES. DO NOT OPERATE THE CART WITHOUT WEARING YOUR SEATBELT AND SAFETY BELT.
9. ALWAYS WEAR YOUR SAFETY BELT AND SAFETY BELT AT ALL TIMES. DO NOT OPERATE THE CART WITHOUT WEARING YOUR SEATBELT AND SAFETY BELT.
10. ALWAYS WEAR YOUR SAFETY BELT AND SAFETY BELT AT ALL TIMES. DO NOT OPERATE THE CART WITHOUT WEARING YOUR SEATBELT AND SAFETY BELT.

**OPERATING INSTRUCTIONS**  
PLEASE READ BEFORE OPERATING

1. ALWAYS WEAR YOUR SAFETY BELT AND SAFETY BELT AT ALL TIMES. DO NOT OPERATE THE CART WITHOUT WEARING YOUR SEATBELT AND SAFETY BELT.
2. ALWAYS WEAR YOUR SAFETY BELT AND SAFETY BELT AT ALL TIMES. DO NOT OPERATE THE CART WITHOUT WEARING YOUR SEATBELT AND SAFETY BELT.
3. ALWAYS WEAR YOUR SAFETY BELT AND SAFETY BELT AT ALL TIMES. DO NOT OPERATE THE CART WITHOUT WEARING YOUR SEATBELT AND SAFETY BELT.
4. ALWAYS WEAR YOUR SAFETY BELT AND SAFETY BELT AT ALL TIMES. DO NOT OPERATE THE CART WITHOUT WEARING YOUR SEATBELT AND SAFETY BELT.
5. ALWAYS WEAR YOUR SAFETY BELT AND SAFETY BELT AT ALL TIMES. DO NOT OPERATE THE CART WITHOUT WEARING YOUR SEATBELT AND SAFETY BELT.
6. ALWAYS WEAR YOUR SAFETY BELT AND SAFETY BELT AT ALL TIMES. DO NOT OPERATE THE CART WITHOUT WEARING YOUR SEATBELT AND SAFETY BELT.
7. ALWAYS WEAR YOUR SAFETY BELT AND SAFETY BELT AT ALL TIMES. DO NOT OPERATE THE CART WITHOUT WEARING YOUR SEATBELT AND SAFETY BELT.
8. ALWAYS WEAR YOUR SAFETY BELT AND SAFETY BELT AT ALL TIMES. DO NOT OPERATE THE CART WITHOUT WEARING YOUR SEATBELT AND SAFETY BELT.
9. ALWAYS WEAR YOUR SAFETY BELT AND SAFETY BELT AT ALL TIMES. DO NOT OPERATE THE CART WITHOUT WEARING YOUR SEATBELT AND SAFETY BELT.
10. ALWAYS WEAR YOUR SAFETY BELT AND SAFETY BELT AT ALL TIMES. DO NOT OPERATE THE CART WITHOUT WEARING YOUR SEATBELT AND SAFETY BELT.

1/1

Note: All labels on this page are not to scale.

MART CART WIRING DIAGRAM

FIGURE 4

MC-02002 PICTORIAL WIRING DIAGRAM

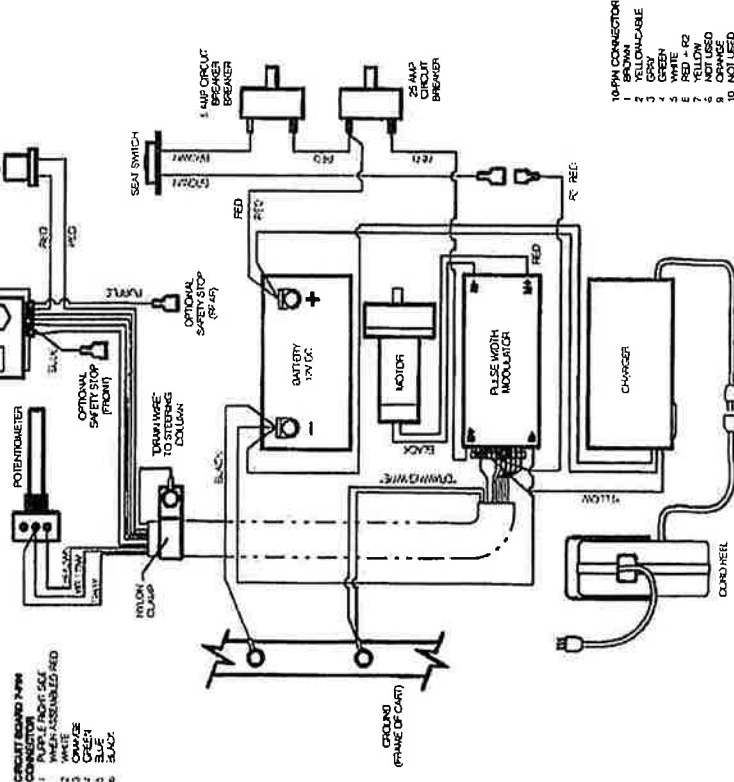

1/1