

132.68 +/- Acres • Lincoln County, SD

LAND AUCTION

Monday, December 5, 2022 – 4:00 p.m.

AUCTION LOCATION: Pifer's Sioux Falls Office: 28020 Boondock Ave. • Worthing, SD

- 118.5 +/- Crop Acres
- 3 Building Eligibilities
- Soil Productivity Index (SPI) of 67.5
- Legal: SE¼ Ex Part & Ex Lot H- in 15-99-51
- Beaver Creek Runs Through the Property
- Excellent Access on County Rd. #116
- Online Bidding Available

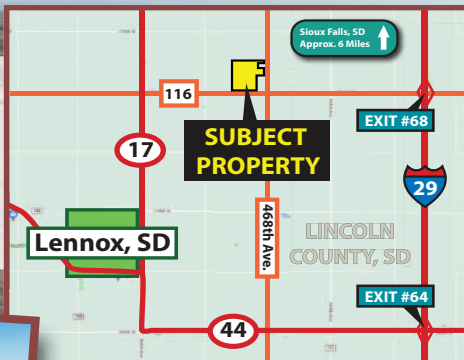

**OWNERS: Renae Bakewell
& Paul Enger**

CONTACTS: Steve Link • 701.361.9985 or Chris Bair • 605.271.7730

This sale is managed by Pifer's Auction & Realty, Firm #12819, Kevin Pifer, SD #12782. All statements made the day of the auction take precedence over all printed materials. The seller reserves the right to accept or reject any and all bids. Pifer's Auction & Realty • 28020 Boondock Ave. - Worthing, SD 57077.

Pifer's
LAND AUCTIONS



www.pifers.com

877.700.4099