

TIMED ONLINE | NO-RESERVE



FARM RETIREMENT AUCTION

**BIDDING CLOSES: WED., DECEMBER 28, 2022
STARTING AT 10:00 AM^{CT}**

PHYSICAL ADDRESS: 2850 FOX AVE., ODEBOLT, IOWA



HIGHLIGHTS: 2012 John Deere 9460RT track tractor, 1,801 hours; 2017 Case-IH 7240 2wd combine, 1,020 eng./839 sep. hours; 2018 Drago GT 8 row 30" twin chopping corn head; 2014 MacDon FD75-S 35' flex draper head; Mauer 35' head trailer; 2019 Brent V700 grain cart; 2015 Kuhn Krause 6200 Landsman 45' soil finisher; 2008 Sunflower 1434 30" disk; John Deere 400 15' rotary hoe; International 490 disk; Killbros 375 gravity wagon w/seed auger & tarp; Killbros 375 Wagon, 12.5L x 16, Westendorf 12 ton running gear.

**LES & LADON SIEBRECHT
EQUIPMENT QUESTIONS: (712) 830-6726**

Auction Manager: DeWayne Ricklefs (712) 830-9105

**VISIT OUR WEBSITE FOR ADDITIONAL DETAILS,
PHOTOS & ONLINE BIDDING CATALOGS!**

LEADERS IN FARMLAND & FARM MACHINERY AUCTIONS

CONSIDERING AN AUCTION?

*Call or Email
Today!*

If you are considering selling farm machinery, real estate or collector cars, our team of professionals is ready to help. Feel free to contact us anytime to learn more about the services we offer. It's never too early to start planning an auction.

CONTACT US TODAY

(844) 847-2161 • WWW.SULLIVANAUCTIONEERS.COM

License #44400107

VIRTUAL ONLINE



STODDARD COUNTY, MISSOURI LAND AUCTION

THURSDAY, JANUARY 12, 2023 AT 10:00 AM^{CT}



120 ACRES± (SUBJECT TO SURVEY) • 1 TRACT

Property is located approximately 4 miles south of Bell City, MO or approximately 17 miles northwest of Sikeston, MO in Sections 25, T27N•11E, Pike Township, Stoddard County, MO.

Land represents highly productive tillable cropland with an excellent location and highway frontage on two sides.

THE CRANDALL FAMILY

Representing Attorney: Raymond C. Lee
Schmiedeskamp Robertson Neu & Mitchell LLP Law Firm
525 Jersey Street | Quincy, IL 62301 | (217) 223-3030

Title Work: Stoddard County Title & Escrow
130 E. Stoddard Street | Dexter, MO 63841 | (573) 624-3325

Auction Managers: Bill Fretwell (660) 341-7735
Jennifer Wood (217) 257-8812 | John Sullivan (309) 221-6700

VIRTUAL ONLINE



SCOTLAND COUNTY, MISSOURI LAND AUCTION

MONDAY, JANUARY 23, 2023 AT 1:00 PM^{CT}



179 ACRES± (SUBJECT TO SURVEY) • 3 TRACTS

The farm is located approximately 1 mile east of Gorin, MO along State Hwy U or approximately 6 miles southwest of Wyaconda, MO in Sections 15 & 16, T64N R10W, Harrison Township, Scotland County, MO.

Farm represents highly productive tillable cropland, blacktop frontage, and offers prime Northern Missouri Whitetail Deer & Wild Turkey Hunting acreage.

THE JOY MUSGROVE FARM

Representing Attorney: David Rouner | Rouner Law Office LLC
400 N. Franklin Street | Kirksville, MO 63501 | (660) 665-7515

Title Work: Oak Hills Title Co.
307 Lewis Street | Canton, MO 63435 | (573) 288-4461

Auction Managers: Bill Fretwell (660) 341-7735 &
Jennifer Wood (217) 257-8812

VIRTUAL ONLINE



PUTNAM COUNTY, ILLINOIS LAND AUCTION

MONDAY, JANUARY 23, 2023 AT 10:00 AM^{CT}



40 TAXABLE ACRES± • 1 TRACT

The Blukel 1959 Land Trust farm is located approximately 5 miles southeast of Granville, Illinois or 12 miles southwest of Peru, Illinois. The property is further described as being located in Section 35, T32-R1W, Granville Township, Putnam County, IL. The real estate contains a total of 40 taxable acres, will be sold in 1 tract and represents highly productive Class A soil.

Farmers and investors, be sure to check out this Putnam County, Illinois, Class A farm with a 144.7 PI.

BLUKEL 1959 LAND TRUST

Representing Attorney: Douglas J. Schweickert
Schwieckert Law Group, LLC | (815) 830-4080
2101 Marquette Road | Peru, IL 61354

Auction Manager: Kevin Haas (309) 264-7767

VIRTUAL ONLINE



MARSHALL COUNTY, ILLINOIS LAND AUCTION

TUESDAY, JANUARY 24, 2023 AT 10:00 AM^{CT}

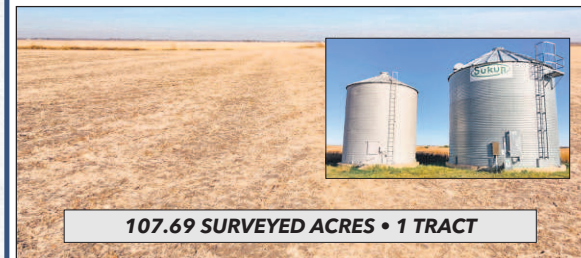

107.69 SURVEYED ACRES • 1 TRACT

The Schumacher farm is located approximately 8 miles west of Toluca, Illinois or 33 miles northeast of Peoria, Illinois and is further described as being located in Section 1, T29N-R2W, Richland Township, Marshall County, Illinois. The real estate contains a total of 107.69 surveyed acres, will be sold in 1 tract and represents highly productive Class A soil.

Farmers and investors, be sure to check out this Class A, Marshall County, Illinois farm.

VIRGINIA SCHUMACHER FARM

Representing Attorneys:

Scott A. Shore | Shore Law and Mediation
PO Box 231 | Hennepin IL 61327 | (815) 925-7117
Christopher Ryan | Attorney At Law
245 NE Perry Ave | Peoria IL 61603 | (309) 637-8020

Auction Manager: Kevin Haas (309) 264-7767



**SULLIVAN
AUCTIONEERS, LLC**