

110 North Wacker Drive, Chicago, IL 60606
www.ggp.com

EASTRIDGE MALL

601 SE WYOMING BLVD
CASPER, WYOMING 82609

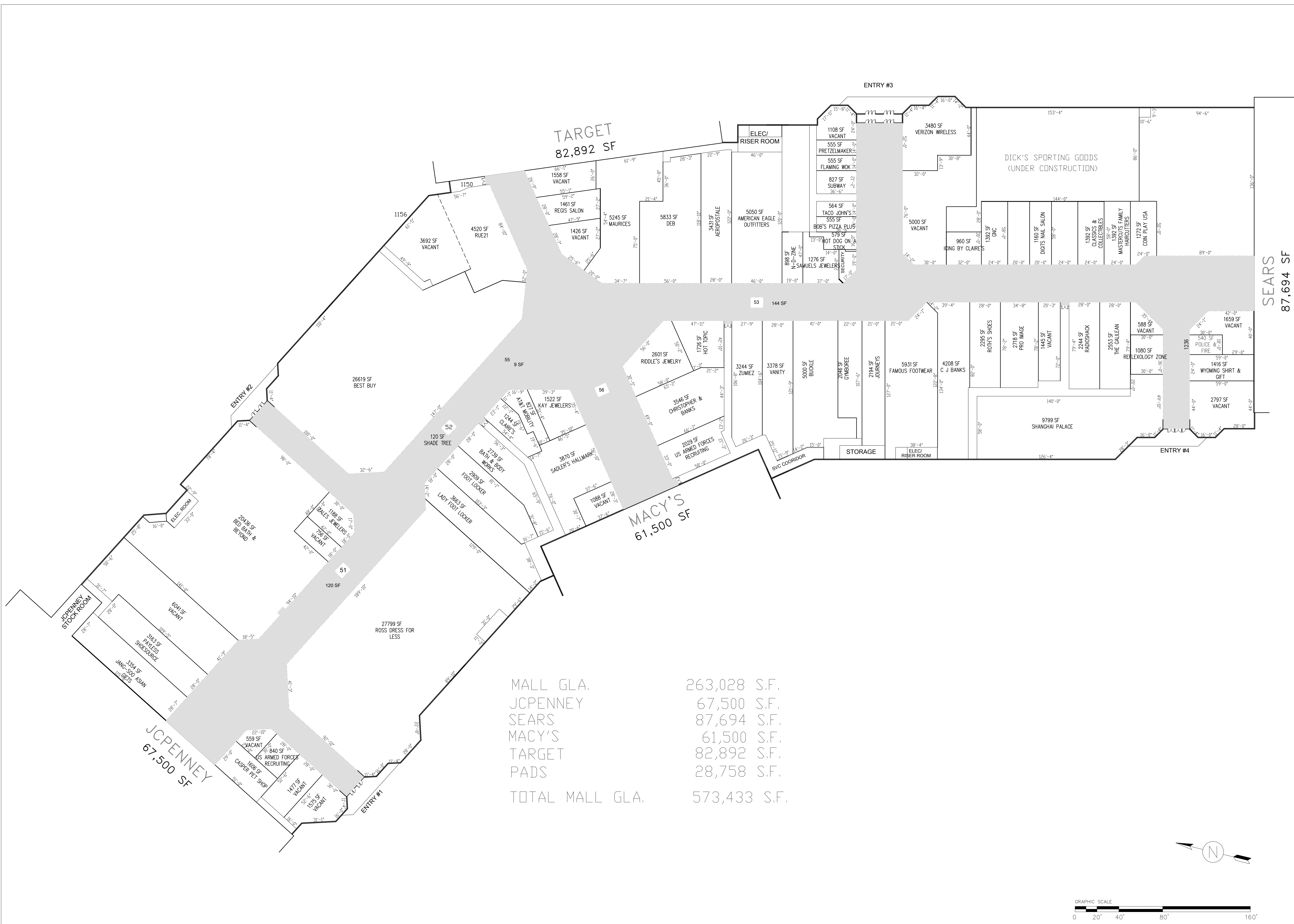

MALL GLA.	263,028 S.F.
JCPENNEY	67,500 S.F.
SEARS	87,694 S.F.
MACY'S	61,500 S.F.
TARGET	82,892 S.F.
PADS	28,758 S.F.
TOTAL MALL GLA.	573,433 S.F.

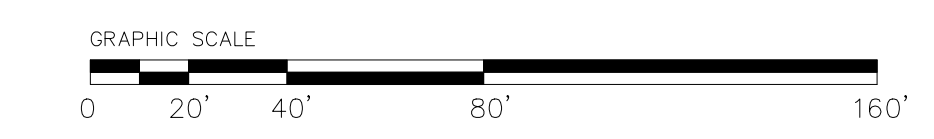
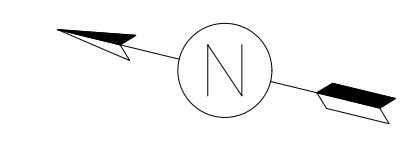

TENANT NAMES SHOWN ON THIS PLAN REPRESENT LEASES WHICH ARE EXECUTED, OUT FOR SIGNATURE, OR IN NEGOTIATION. SPECIFIC NAMES, LOCATIONS, DIMENSION OF ANY STORE, ENTRANCE, OR IMPROVEMENT ARE SUBJECT TO CHANGE, MODIFICATION AND DELETION BY LANDLORD OR OTHER PARTIES, AND ARE NOT A REPRESENTATION OF, OR WARRANTY AS TO THE OPENING OR CONTINUED OPERATION OF ANY STORE NAMED OR DEPICTED ON THIS PLAN.

NOTWITHSTANDING THAT CERTAIN OF THE ELEMENTS, INCLUDING BUT NOT LIMITED TO THE TENANT NAMES, SHOWN ON THIS PLAN MAY BE INDICATED AS FUTURE OR PROPOSED, LANDLORD MAKES NO REPRESENTATION THAT THE FUTURE DEVELOPMENT WILL OCCUR AS SHOWN.

ALL TENANT LEASE AREAS ARE MEASURED FROM THE CENTERLINE OF INTERIOR PARTITION, FROM THE OUTSIDE FACE OF EXTERIOR WALL, FROM THE FULL THICKNESS OF CORRIDOR AND SHIRT WALLS AND FROM THE EDGE OF SLAB AT ANCHOR STORE WALLS.

PROJECT NO: 3092
DRAWN BY: DM
COPYRIGHT: General Growth Properties, Inc.

DESCRIPTION

LEASE PLAN

SHEET NO.

LP1

DATE: March 2013